

T-shaped quick connector for 2 wires - 0.34~0.78 mm² - 300V / 9A

Ref. WJ-T-2C

Quick T connector for 2 series cables, supports up to 300V and 9A. Compatible with cables of Ø 0.34-0.78mm². Indoor use, IP40. **Does not include cable**

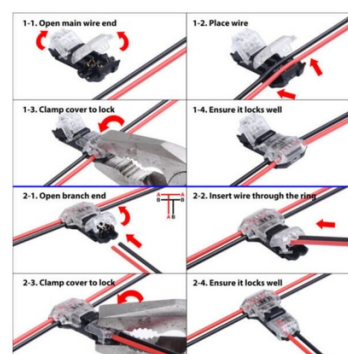

Product data

High	6.3 mm
Width	16.2 mm
Certs	CE, ROHS
Guarantee	According to legal warranty: 3 years
Maximum intensity (A)	9
IP	IP40
Long	28.2mm

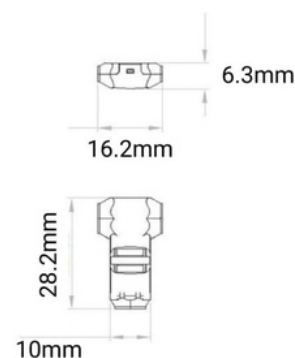

Product variants

Reference

Attributes



WJ-T-2C