

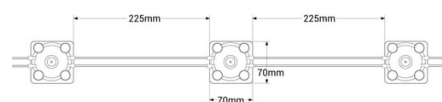

LED module for illuminated signs - 3.6W - 220V AC - IP65 - 165° - 6000K

The LED modules provide uniform and decorative lighting, ideal for advertising signs and special projects. The module features 4 integrated SMD3030 LEDs, a total power of 3.6W, and a 3M adhesive base. Its installation is very simple and due to its high degree of airtightness, IP65, this product can be used outdoors. Available in warm white (3000K). Dimensions: 70 x 70mm *The price is per module*



Product data

Light temperature	3000°K (use), 4000°K (use), 6000K (use)
Adhesive	3M
Opening angle (°)	165
Certs	CE, ROHS
Dimensions (mm) LxWxH	70 x 70 x 9
Guarantee	According to legal warranty: 3 years
IP	IP65
Material	Polycarbonate
Power (W)	3.6
Nominal Voltage (V)	220 - 240 V AC
Type of LED	SMD 3030
Key	Warm white, Cold white, Neutral white
Outdoor Use	If
Recommended Use	Commerce, Butcher shops
Kelvin (K)	4000, 6000
High	9mm
Width	70mm
Long	70mm

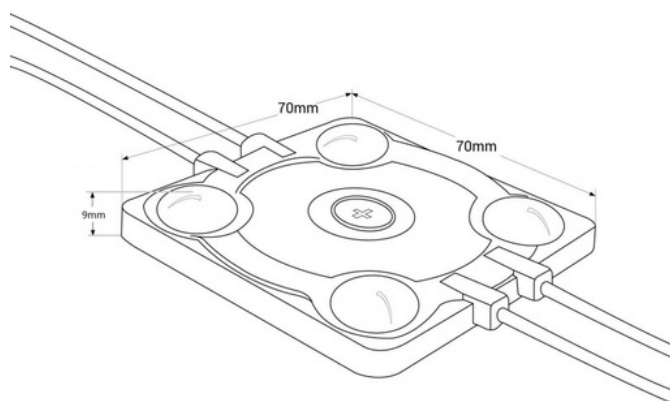

Product variants

Reference	Attributes	
BM1428BC	Light temperature : 3000°K (use)	
BM1428BF	Light temperature : 6000K (use)	
BM1428BN	Light temperature : 4000°K (use)	