

# 10mm

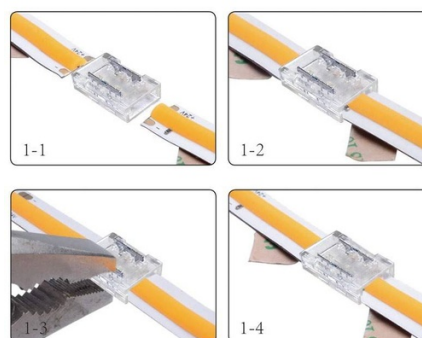
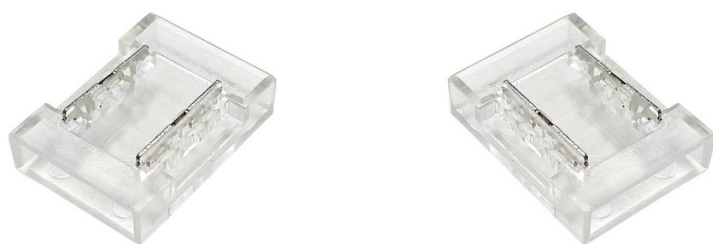

## Connector for strip to strip COB CLIP INVISIBLE 2 pin 10mm IP20

Ref. G-B2P-10

COB strip to COB strip connector, which allows for the connection of two high-density LED strips together. Made with an invisible structure to avoid dark spots. Suitable for linear lighting of COB strips. 2 Pin. For IP20 LED strips 10mm wide. Connect strips without the need for soldering. Protection rating IP20, for indoor use only. Dimensions of 12x16x3mm and an intensity of 5A. Allowed voltage 0-36V.



### Product data

Track width (mm)	10
Certs	CE, ROHS
Dimensions (mm) LxWxH	12x16x3
Guarantee	According to legal warranty: 3 years
IP	IP20
Material	ABS
Temperature range	-20°F ~ +40°F
Nominal Voltage (V)	0-36V-DC
Outdoor Use	No

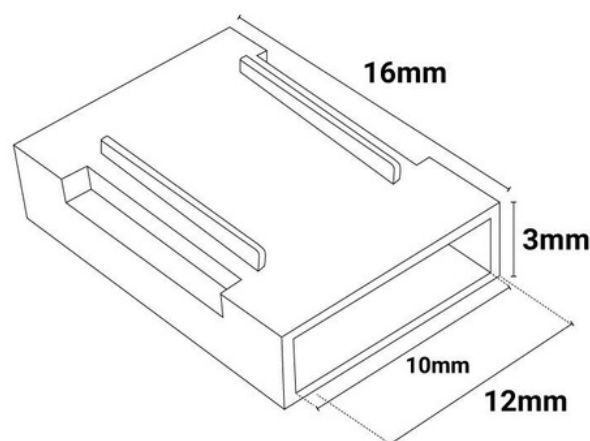

Product variants

Reference

Attributes

10mm



G-B2P-10