

8mm

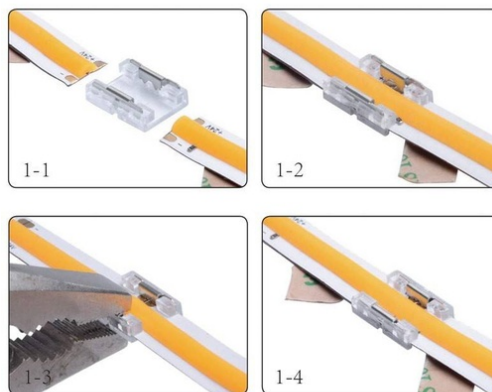

Quick connector CLIP INVISIBLE 2 pin strip to strip connection single color 8mm IP20

Ref. BCI8BB-2

Quick connector between LED strips, for monochrome LED strips, designed to fit inside aluminum profiles. 2 Pin, completely invisible, eliminating the dark area caused by conventional connectors. For indoor use, protection degree IP20. Suitable for 8mm PCB IP20 LED strips, unboiled. With dimensions of 15.6x9.6x3.3mm and an intensity of 5.5A. Accepted voltage 3-24V.



Product data

Track width (mm)	8
Certs	CE, ROHS
Dimensions (mm) LxWxH	15.6 x 9.6 x 3.3
Guarantee	According to legal warranty: 3 years
IP	IP20
Material	ABS
Temperature range	-20°F ~ +40°F
Control system	Monochrome
Nominal Voltage (V)	3-24V-DC
Outdoor Use	No

Product variants

Reference

Attributes

8mm



BCI8BB-2