

INSTALLATION

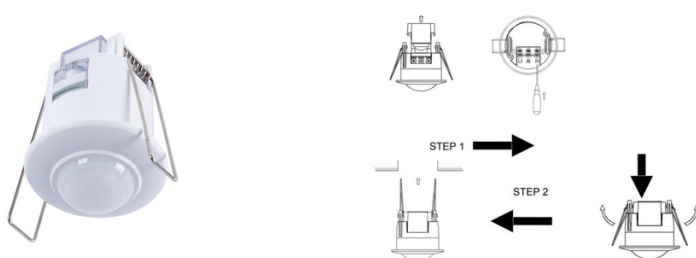

Connection Sketch Figure

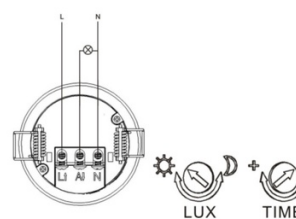

Mini 360° recessed PIR motion sensor - IP20

Ref. SP14A

Compact infrared motion detector (PIR) for installation in indoor ceilings, with an IP20 protection rating. Its infrared sensor allows detection when someone enters its field at a 360° angle and a range of up to 6 meters. It is capable of identifying light during night and day, allowing for the effective use of energy from LED products. Maximum supported power of 150W (LED) and 500W (incandescent).

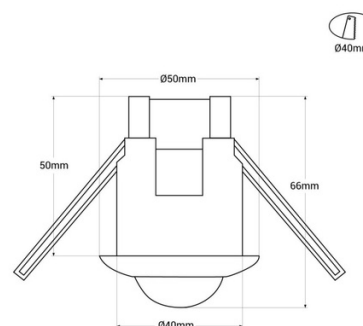

Product data

Detection angle (°)	360
Certs	CE, ROHS
Frequency (Hz)	50 - 60
Frequency of Use	Intensive
Guarantee	According to legal warranty: 3 years
IP	IP20
Material	Polycarbonate
Assembly	Recessed
Orientable	No
Maximum power (W)	400
Detection range (m)	0-6
Temperature range	-20°F ~ +40°F
Nominal Voltage (V)	220 - 240 V AC
Type of sensor	PIR
Outdoor Use	No

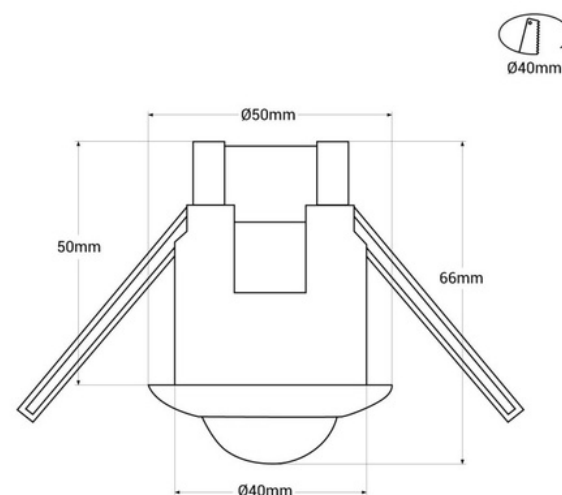

Product variants

Reference

Attributes



SP14A