

160° square PIR wall-mounted motion sensor

Ref. S3136

Infrared sensor with a 160° detection angle, capable of detecting up to 8 meters, for devices or load accumulation up to 500W. For LED lights up to 200W. Easy automation switch for lighting with the sensor. Works in three-wire installations and can turn on and off all types of lights. Mini Sensor ideal for replacing flush-mounted switches and automating lights in hallways, staircases, or bathrooms almost instantly, exclusively for indoor use with IP20 protection rating. It operates in installations with 3 wires. Thanks to the integrated button, manual switching is possible at any time.

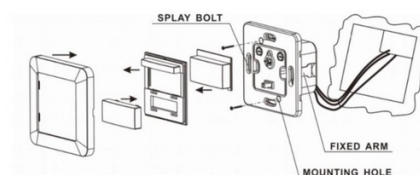

Product data

Certs	CE, ROHS
Energy efficiency class	A+ (2021)
Connectivity	PIR
Dimensions (mm) LxWxH	80x80x49
Frequency (Hz)	50
Frequency of Use	Intensive
Guarantee	According to legal warranty: 3 years
IP	IP20
Material	Plastic
Assembly	Surface
Orientable	No
Maximum power (W)	200
Detection range (m)	8
Temperature range	-20°F ~ +40°F
Outdoor Use	No

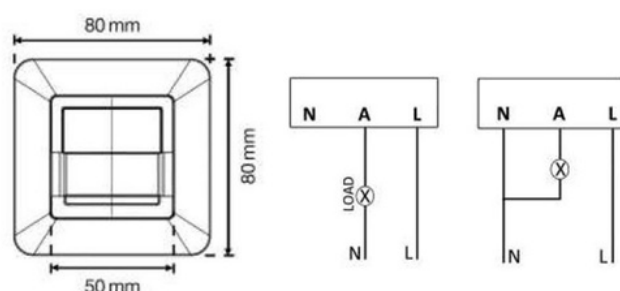

Product variants

Reference	Attributes
S3136	